

# Lumax Cornaglia Auto Technologies Pvt. Ltd.

**Duns No. 650462885**





Year	Milestone
2007	Incorporation of JV
2009	Start of supplies for AIS to <b>TATA &amp; FIAT</b>
2009	<b>VW Brand</b> added in Customer Portfolio
2010	Industrialization of <b>Filter Cartridges</b> Manufacturing Technology
2010	<b>ISO/TS 16949 : 2002 Certification</b> (by TUV Rheinland)
2011	<b>General Motors</b> added in Customer Portfolio
2011	Industrialization of <b>3D Blow Moulding</b> Manufacturing Technology
2012	<b>ISO 14001 &amp; BS OHSAS 18001:2007 Certification</b> (by TUV Rheinland)
2012	<b>Exhaust System</b> business awarded by TATA
2014	SOP for Exhaust System

## AIR INTAKE DIVISION

Complete Air Intake systems and plastics components



## AIR FILTER ELEMENT MFG (Part of Air Intake Division)

Filter Element/Cartridges



## 3D BLOW MOULDING DIVISION

Intake Ducts & Charge Air Cooler Ducts



## EXHAUST SYSTEM DIVISION

Complete Exhaust and After Treatment Systems



## ENGINEERING & DEVELOPMENT CENTRE

Under Development (V2020)  
(Currently Group Resources being used)



1.2P



1.3D



1.4P



1.6P

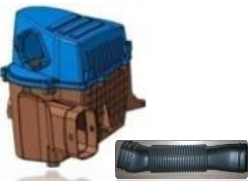

1.5D

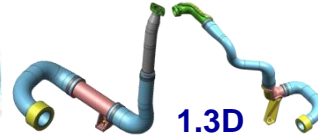

1.3D



1.2P



1.3D



1.05D



1.3D



1.4P



1.2P



1.2P

FY2015-16



**ACMA SILVER AWARD –  
Excellence in Quality & Productivity**

FY2016-17



**ACMA GOLD AWARD –  
Excellence in Quality & Productivity**

---

# Manufacturing Technologies



**Paper Pleating Line**



**Hot Plate Welding**



**PU Dispensing Line**

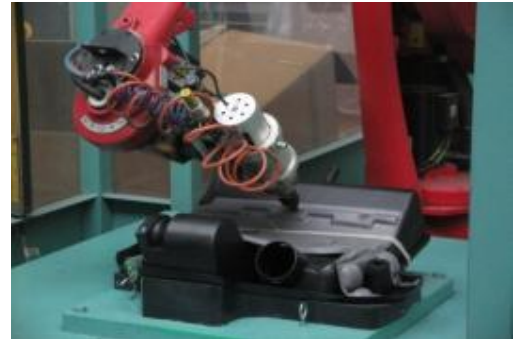

**Ultrasonic Welding**



**Vibration Welding**

Installed Capacity : 750000 ppa (based on 2-shift working)



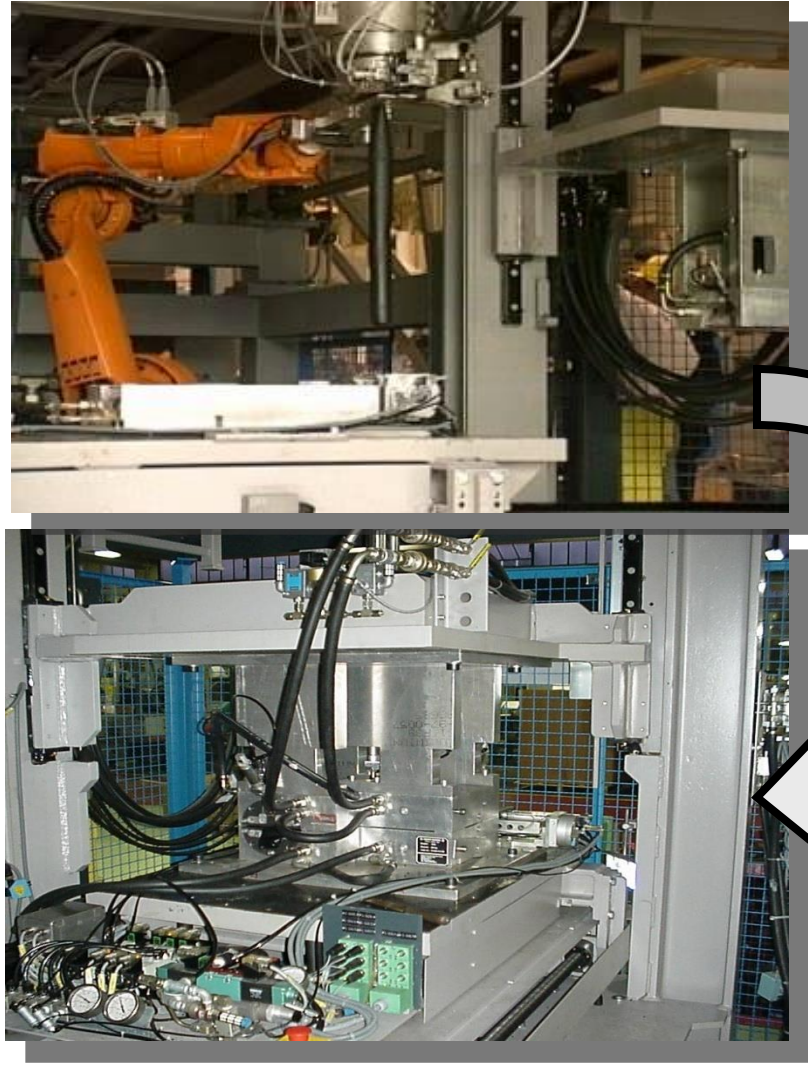

Installed Capacity : 195000 ppa (based on 2-shift working)



Robotic Welding Cell – Exmani + Catcon